



Montageinformation

Dachträger „Profil 2000“

BMW 3er-Reihe und BMW 5er-Reihe

Installation information

Informations concernant le montage

Montage-informatie

Monteringsinformation

Informazioni per il montaggio

Información de montaje

Informações de montagem



© 2001 Bayerische Motoren Werke

Aktiengesellschaft

München/Deutschland

Nachdruck, auch auszugsweise, nur mit
schriftlicher Genehmigung der BMW AG, München.

Bestell-Nr. 01 29 0 137 514 / Montageinformation
VIII/ 01

Printed in Germany

Gedruckt auf umweltfreundlichem Papier

(chlorfrei gebleicht, wiederverwertbar).

Druckfehler, Irrtümer und Änderungen vorbehalten.

Roof bar “Profil 2000” BMW 5 Series and BMW 3 Series

Instructions for the installation information

Read this installation information carefully before you install the roof bar. If you fail to follow the instructions in the installation information, the BMW Group cannot accept any liability and all warranty claims against the BMW Group will be rendered void.

Symbols used



denotes instructions of warnings that you must observe. ◀



denotes instructions that draw your attention to special features. ◀

◀ denotes the end of a piece of information or an instruction.

For your own safety



Only use parts and accessory products that have been approved by BMW.

The BMW Group cannot any liability for other products. ◀

Safety instructions

BMW 3 Series: Do not exceed the roof load of 75 kg (the weight of both bars is 4.3 kg plus attachments plus payload).

BMW 5 Series: Do not exceed the roof load of 100 kg (the weight of both bars is 4.3 kg plus attachments plus payload).

Check all screw connections and connections on the supports and attachments before every journey to ensure that they are tight and tighten them if necessary.



On long journeys in particular the screw connections between the roof bars and the car roof must be checked at regular intervals (at least every 1000 km) to ensure that they are tight and tightened if necessary. If you are driving over poor road surfaces, check the screw connections every two hours. ◀

Distribute the load evenly and keep the centre of gravity as low as possible as well as securing the load with suitable lashing straps to prevent its moving.

Follow the regulations of the Road Traffic Act and national regulations for roof loads.

When carrying loads on your roof adjust your speed to the objective conditions (road condition, road surface, side wind, etc.) and the general traffic conditions. We recommend that you adhere to the guide speed.

General instructions

Keep the enclosed "Safety certificate" with its letter code in a safe place so that you can order a new coded wrench from your BMW dealer if you lose the original one.

Parts kit	18
Default adjustment of the roof bar	19
To install the roof bar	23

18 Parts kit

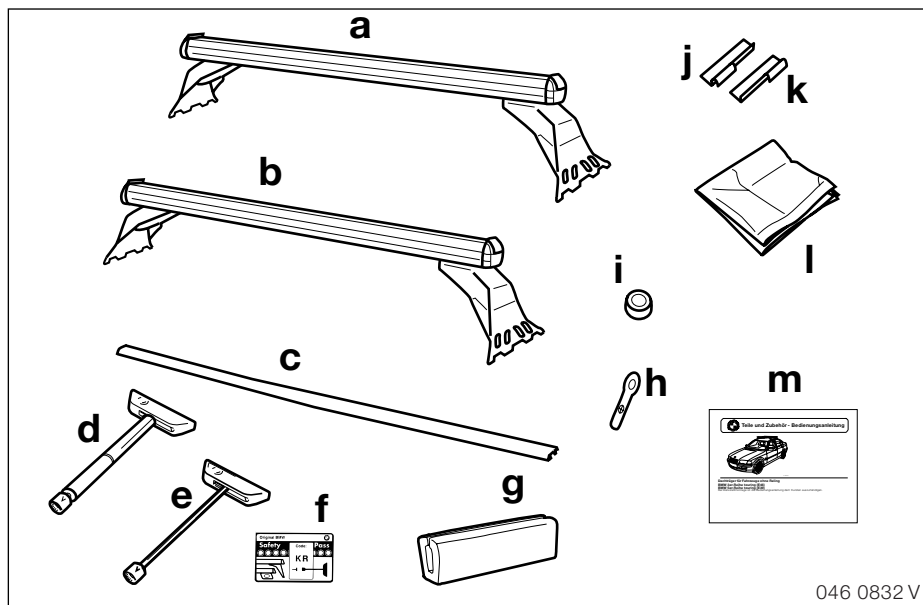

046 0832 V

a Front roof bar	1	f Safety certificate	1	l Cleaning cloth	1
b Rear roof bar	1	g Installation tool	1	m Installation information	1
c Cover strip	2	h Gutter strip opener	1		
d Special wrench for 3 Series compact	1	i Cover cap	4		
e Special wrench for 5 Series and 3 Series except compact	1	j Gutter protector, left	4		
		k Gutter protector, right	4		

Default adjustment of the roof bar



The following figures show the gutter on the BMW 3 Series. On the BMW 3 Series there are two struts in the gutter recess, which are not present on the BMW 5 Series. The installation work for the roof bar on the BMW 5 Series is therefore almost identical.

The installation work is shown on the front roof bar. Proceed in exactly the same way to install the rear roof bar. ◀

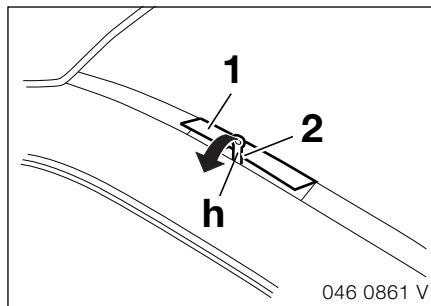

Insert the gutter opener (h) into the recess (2) on the gutter flap (1) and press it in the direction indicated by the arrow. Open the gutter flap until it locks into position.

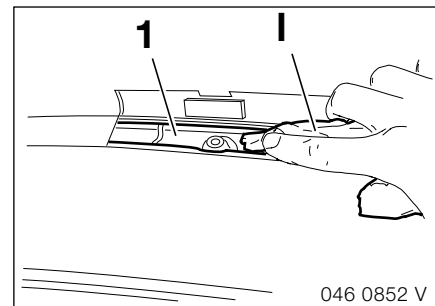

Clean the gutter (1) using the cleaning cloth (l) to ensure that the gutter protector will adhere properly.

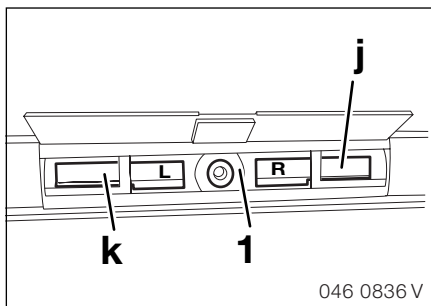

▶ After cleaning the gutter wait for approximately five minutes before you affix the gutter protector into the gutter.

Ensure that you do not affix the gutter protectors (j) and (k) into the sealing area (1) for the threaded bush. ◀

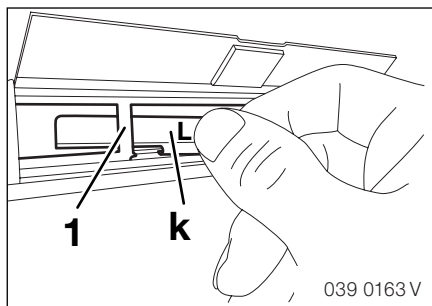

▶ **Instructions for use:** The ideal temperature for the work is 20°C. If it is not possible to complete the work in this temperature, we recommend that you leave the roof bars on the roof for 24 hours afterwards. ◀

Slide the gutter protector (k) bearing the letter L under the left connector (1) on the gutter flap and affix the gutter protector to the surface of the gutter so that it covers the vertical metal edge.

Proceed in the same way with the right gutter protector bearing the letter R.

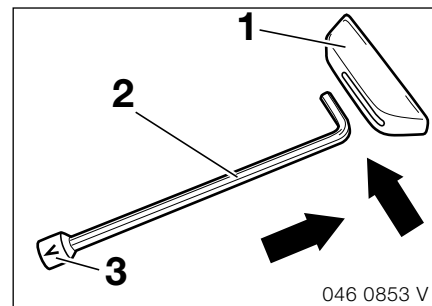

▶ The special wrench has two functions. When the handle (1) is removed the angle wrench (2) is used as an Allen key for tightening and undoing the Allen bolts. The angle wrench (2) must be connected to the handle (1) (see arrows) to tighten the coded screws. ◀

To attach the wrench to the code screw line up the arrows on the screw with those on the special wrench (3).

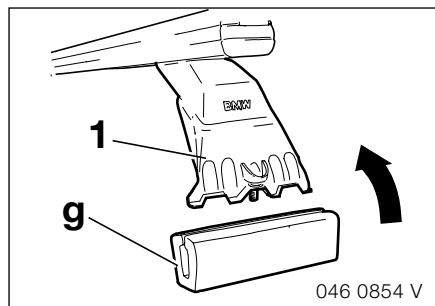

▶ There is a sticker on the inside of the support feet that indicates the appropriate installation site on the car. The left support foot is preset and does not need to be adjusted. The screws have cover caps. ◀

Place the installation tool (g) on the left support foot (1) on the roof bar.

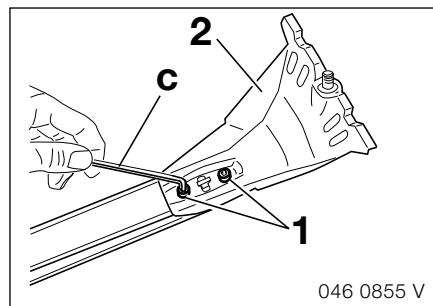

▶ The default adjustment is shown on the front roof bar. Proceed in exactly the same way to adjust the rear roof bar. ◀

Undo the Allen bolts (1) on the right-hand side using the special wrench (c) until the support foot (2) slides easily.

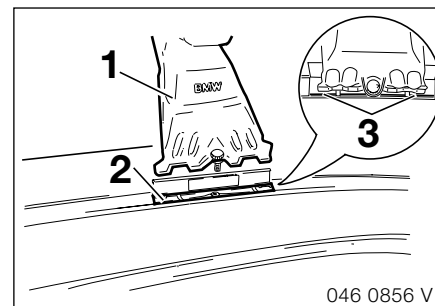

⚠ Ensure that the support foot (1) runs parallel to the metal edge (3) in the gutter. ◀

Place the roof bar with the support feet (1) carefully into the roof bar recess (2) in the gutter.

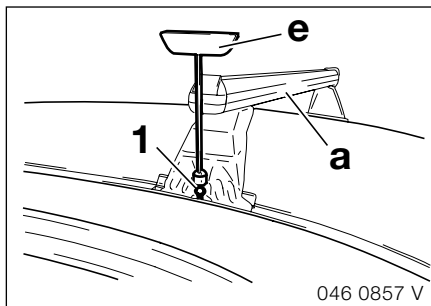

Tighten the coded screws (1) slightly with the special wrench (e).

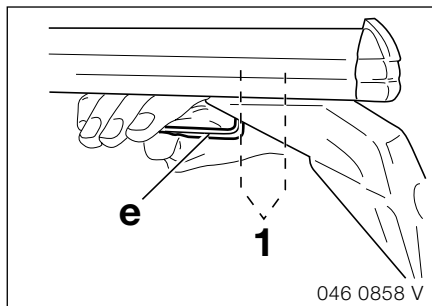

Tighten the Allen bolts (1) with the special wrench (e). Take the roof bar back off the roof and tighten the Allen bolts completely. Place the cover caps on the Allen bolts.

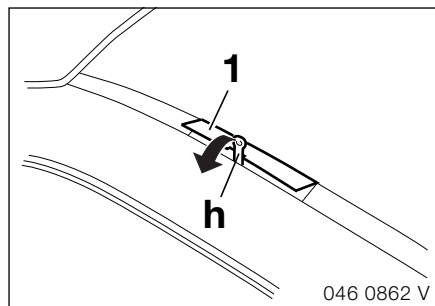

Open the gutter flap (1) with the gutter opener (h).

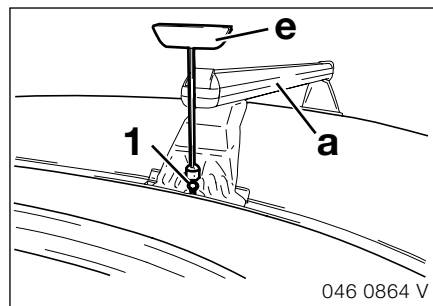

 Ensure that there is a spring washer under the head of the screw. Never insert the screw without the spring washer. Replace the spring washer immediately if it is missing. ◀

BMW 5 Series and BMW 3 Series except compact

Position the roof bar carefully and tighten the coded screws (1) with the special wrench (e).

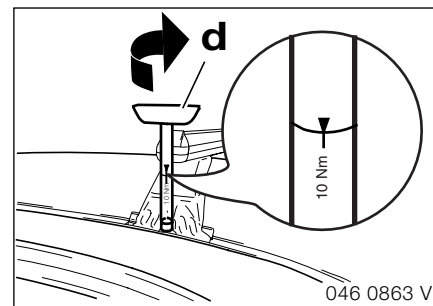

BMW 3 Series compact

Position the roof bar carefully and tighten the coded screws (1) with the special wrench (d) until the two markings on the special wrench line up.

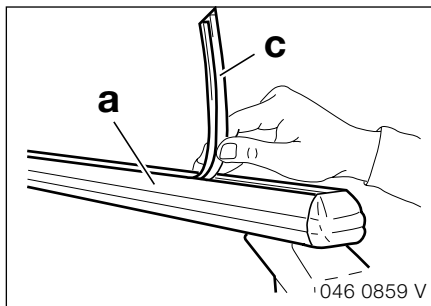

Press the cover strip (c) into the roof bar (a).



The cover strip protects the bar from dirt. ◀

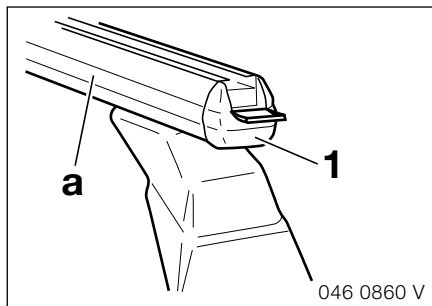

Refer to the appropriate installation instructions for details of how to install and secure the attachments. ◀

Remove the cover strip and open the cover caps (1) to install attachments. Push the attachments into the profile rail in the roof bar (a). Close the cover caps (1) after securing the attachments.



Freude am Fahren